



## Fence Setbacks

**Boundary fence - Wood:** Must be placed not closer than three feet from any property line, except it shall not be placed within five feet of an alley and no fence can be located within any corner side setback for corner lots. Fences also cannot be placed in any required front yard setback area.

**Boundary fence - Chainlink:** Must be placed no closer than one foot from any property line, except that it shall not be placed within five feet of an alley and no fence can be located within any corner side setback for corner lots. Fences also cannot be placed in any required front yard setback area.

**ALL MEASUREMENTS MUST BE FROM YOUR LOT LINES – NOT STREET OR ALLEY SURFACES.**

## SAMPLE SKETCH

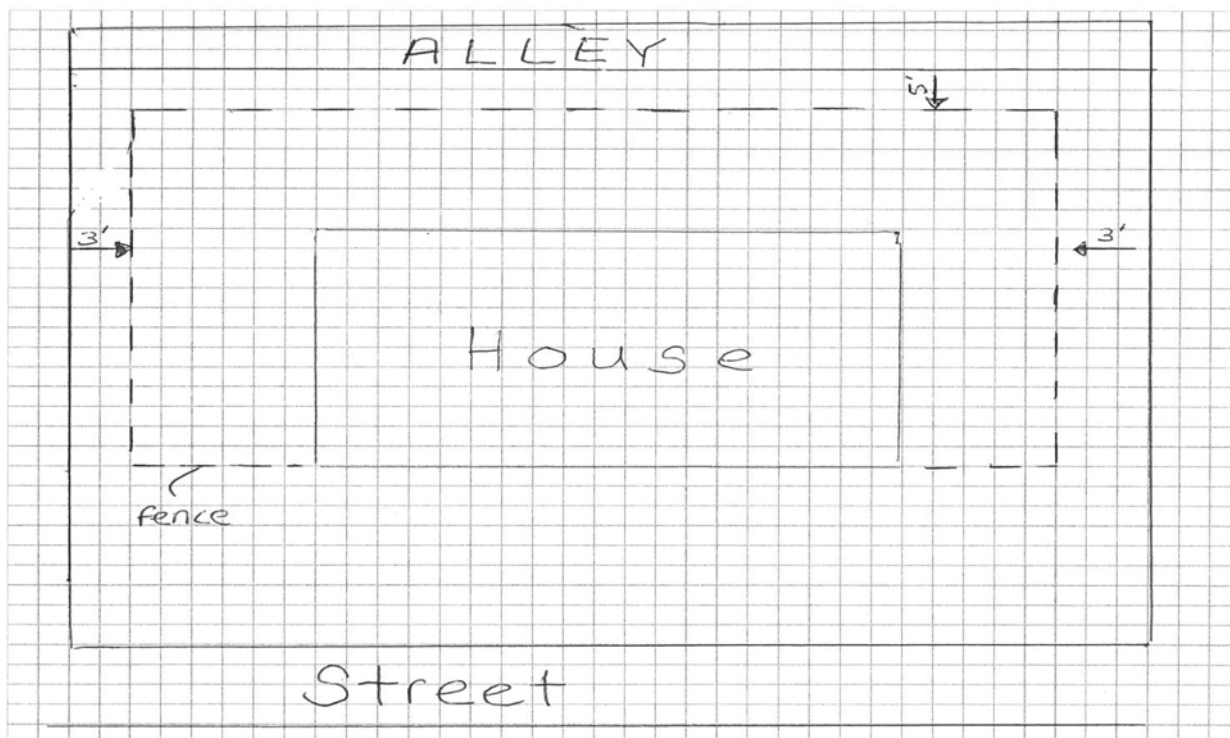



**SEE BELOW FOR THE COMPLETE LIST OF REGULATIONS PERTAINING TO FENCES AND HEDGES PLEASE REFER TO OUR CITY CODE SECTION SEC. 42-788.**

- **Sec. 42-788. - *Fences* and hedges.**
  - (a) *Fences defined.* For the purpose of this section, a fence is defined as an enclosed barrier consisting of vegetation, wood, stone or metal intended to prevent ingress or egress. For the purpose of this section, the term "fence" shall include plantings, such as hedges and shrubbery.
  - (b) *Fences categorized.* Fences shall be categorized into two classifications:
    - (1) *Boundary fence.* A fence which is placed in a location such that it effectively defines all or a portion of a boundary of a property. Such *fences*, unless the fence is constructed as a chainlink fence, must be placed not closer than three feet from any property line except it shall not be placed within five feet of an alley, if applicable. If the fence is a chainlink fence, it must be constructed not less than one foot from any property line except it shall not be placed within five feet of an alley, if applicable.
    - (2) *Protective fence.* A fence constructed to enclose a hazard to the public health, safety and welfare.
    - (3) *Architectural or aesthetic fence.* A fence constructed to enhance the appearance of the structure or the landscape.
  - (c) *Location regulations.*
    - (1) Except as provided in [section 42-710](#), a fence, wall, hedge or shrubbery may be erected, placed, maintained or grown on property in accordance with the location provisions of this section to a height not exceeding six feet above the ground level, except that no such fence, wall, hedge or shrubbery which is located in a corner side yard shall exceed a height of three feet. Where such lot line is adjacent to nonresidentially zoned property, there shall be an eight foot limit on the height of a fence, wall, hedge or shrubbery along such lot line.
    - (2) No fence, wall, hedge or shrubbery shall be erected, placed, maintained or grown along a lot line on any nonresidentially zoned property, adjacent to residentially zoned property, to a height exceeding eight feet.



(3) In any residence district no fence, wall, hedge or shrubbery shall be erected, constructed, maintained or grown to a height exceeding three feet above the street grade nearest thereto, within 25 feet of the intersection of any street lines or of street lines projected.

(4) Fences in or adjacent to a residential property shall have a minimum three-foot setback.

(5) *Front yard fences.* In any residence district, all *fences* located within a required front yard shall be decorative only and limited to a maximum of 50 percent in opacity. Decorative *fences* located within any portion of a required front yard shall have a minimum three-foot setback from the front property line and shall also have a minimum three-foot setback from any driveway. No decorative fence located within any portion of a required front yard shall exceed a height of four feet above the ground level, except that decorative fence post caps shall not exceed more than 12 inches above the maximum fence height of four feet. Day-glow paints or colors are not permitted on a decorative fence located within any portion of a required front yard. Chain-link, wire-mesh and privacy *fences* are not permitted within any portion of a required front yard.

(6) The finished side of a fence shall face outward from the property on which the fence is located. The side of a fence containing the posts or poles and other bracing appurtenances shall face inward to the property being fenced in or on which the fence is located.

(Code 1986, § 10-1-142(b)(1), (c)(1); Ord. No. 91-11, §§ 1, 2, 7-15-1991; Ord. No. 2000-06, §§ 1, 2, 7-10-2000; Ord. No. 2002-07, § 1, 6-24-2002; Ord. No. 2008-02, § 1, 3-25-2008)